

URBAN MEADOWS

A SUBDIVISION
IN THE NW 1/4 OF THE SE 1/4,
AND THE SW 1/4 OF THE NE 1/4
OF SECTION 2
T. 4 N., R 1 E., W. M.,
CITY OF LA CENTER
CLARK COUNTY, WASHINGTON
SHEET 2 OF 2

BK 312 P 317 2/2

BK 312 P 317 2/2

35

CALCULATED POSITION OF
OF QUARTER CORNER AS SHOWN IN S1
SEE L.C.R. 15-190

N 88°42'21" W
(590.50' SI)

S 63°36'18" E
(34.63' SI)

N 28°23'42" E
(125.00' SI)

N 28°23'42" E
(125.00' SI)

N 28°23'42" E
(125.00' SI)

N 28°23'42" E
(125.00' SI)

N 28°23'42" E
(125.00' SI)

N 28°23'42" E
(125.00' SI)

N 28°23'42" E
(125.00' SI)

N 28°23'42" E
(125.00' SI)

N 28°23'42" E
(125.00' SI)

N 28°23'42" E
(125.00' SI)

N 28°23'42" E
(125.00' SI)

N 28°23'42" E
(125.00' SI)

N 28°23'42" E
(125.00' SI)

N 28°23'42" E
(125.00' SI)

N 28°23'42" E
(125.00' SI)

N 28°23'42" E
(125.00' SI)

N 28°23'42" E
(125.00' SI)

N 28°23'42" E
(125.00' SI)

N 28°23'42" E
(125.00' SI)

N 28°23'42" E
(125.00' SI)

N 28°23'42" E
(125.00' SI)

N 28°23'42" E
(125.00' SI)

N 28°23'42" E
(125.00' SI)

N 28°23'42" E
(125.00' SI)

N 28°23'42" E
(125.00' SI)

N 28°23'42" E
(125.00' SI)

N 28°23'42" E
(125.00' SI)

N 28°23'42" E
(125.00' SI)

N 28°23'42" E
(125.00' SI)

N 28°23'42" E
(125.00' SI)

N 28°23'42" E
(125.00' SI)

N 28°23'42" E
(125.00' SI)

N 28°23'42" E
(125.00' SI)

N 28°23'42" E
(125.00' SI)

N 28°23'42" E
(125.00' SI)

N 28°23'42" E
(125.00' SI)

N 28°23'42" E
(125.00' SI)

N 28°23'42" E
(125.00' SI)

N 28°23'42" E
(125.00' SI)

N 28°23'42" E
(125.00' SI)

N 28°23'42" E
(125.00' SI)

N 28°23'42" E
(125.00' SI)

N 28°23'42" E
(125.00' SI)

N 28°23'42" E
(125.00' SI)

N 28°23'42" E
(125.00' SI)

N 28°23'42" E
(125.00' SI)

N 28°23'42" E
(125.00' SI)

N 28°23'42" E
(125.00' SI)

N 28°23'42" E
(125.00' SI)

N 28°23'42" E
(125.00' SI)

N 28°23'42" E
(125.00' SI)

N 28°23'42" E
(125.00' SI)

N 28°23'42" E
(125.00' SI)

N 28°23'42" E
(125.00' SI)

N 28°23'42" E
(125.00' SI)

N 28°23'42" E
(125.00' SI)

N 28°23'42" E
(125.00' SI)

N 28°23'42" E
(125.00' SI)

N 28°23'42" E
(125.00' SI)

N 28°23'42" E
(125.00' SI)

N 28°23'42" E
(125.00' SI)

N 28°23'42" E
(125.00' SI)

N 28°23'42" E
(125.00' SI)

N 28°23'42" E
(125.00' SI)

N 28°23'42" E
(125.00' SI)

N 28°23'42" E
(125.00' SI)

N 28°23'42" E
(125.00' SI)

N 28°23'42" E
(125.00' SI)

N 28°23'42" E
(125.00' SI)

LACENTER
SCHOOL
DIST#101
PIN: 209120000

FOUND AND HELD 5/8" IRON ROD WITH
ORANGE PLASTIC CAP STAMPED
"BESEDA 34127" SET IN S1

FOUND AND HELD 5/8" IRON ROD WITH
ORANGE PLASTIC CAP STAMPED
"BESEDA 34127" SET IN S1

FOUND AND HELD 5/8" IRON ROD WITH
ORANGE PLASTIC CAP STAMPED
"BESEDA 34127" SET IN S1

FOUND AND HELD 5/8" IRON ROD WITH
ORANGE PLASTIC CAP STAMPED
"BESEDA 34127" SET IN S1

FOUND AND HELD 5/8" IRON ROD WITH
ORANGE PLASTIC CAP STAMPED
"BESEDA 34127" SET IN S1

FOUND AND HELD 5/8" IRON ROD WITH
YELLOW PLASTIC CAP STAMPED "FOSTER 21675" AS SHOWN IN S1

MCDONALD
JANINE
PIN: 209108000

- LEGEND:**
- INDICATES MONUMENT FOUND AS NOTED
 - INDICATES CALCULATED POSITION
 - ⊙ INDICATES 5/8" x 30" REBAR WITH BLUE PLASTIC CAP "WALS 48747 ORLS 87015" SET 06-01-2024
 - + INDICATES ROCK NAIL WITH BRASS WASHER INSCRIBED "BROWN 48747" SET AT THE 8.75' EXTENSION OF LOT LINE IN THE CURB UNLESS OTHERWISE NOTED SET 06-01-2024
 - L.C.R. INDICATES LAND CORNER RECORD
 - SQ. FT. INDICATES SQUARE FEET
 - N.T.S. INDICATES NOT TO SCALE
 - INDICATES BOUNDARY
 - - - INDICATES CENTERLINE
 - - - INDICATES RIGHT OF WAY
 - - - INDICATES DRIPLINE

GRAVITATE
CAPITAL, LLC
PIN: 208846000

FOUND AND HELD 1/2" IRON ROD WITH
YELLOW PLASTIC CAP STAMPED
"MINISTER 12563" AS SHOWN IN S1

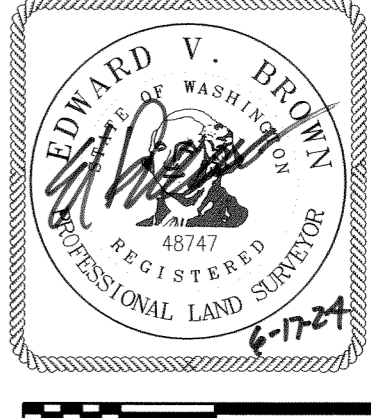

BASIS OF BEARING:
N 01°06'36" E ALONG THE EAST LINE OF S1
BETWEEN MONUMENTS FOUND

SCALE 1 INCH = 50 FEET

SCALE: 1"=50'
JOB NO. 23-080
DATE: 06-17-24
CALC BY: EVB
DRAWN BY: EVB
CHECKED BY: EVB
SHEET 2 OF 2

BROWN
SURVEYING PLLC
PO BOX 414
AMBOY, WA 98601
360-600-0846
ebrownsurveying@gmail.com

BK 312 P 317 2/2

BK 312 P 317 2/2